

**ALUMINIUM REINFORCED  
ANTI-SLIPPAGE  
ATTACHMENT**

**RECESSED BAYONET STYLE KNOB**  
Easy open, push and turn

**SPECIALLY MOUNTED EYELETS  
FOR ADDED SECURITY**

**MAXI-LINE®**  
by Arnetoli

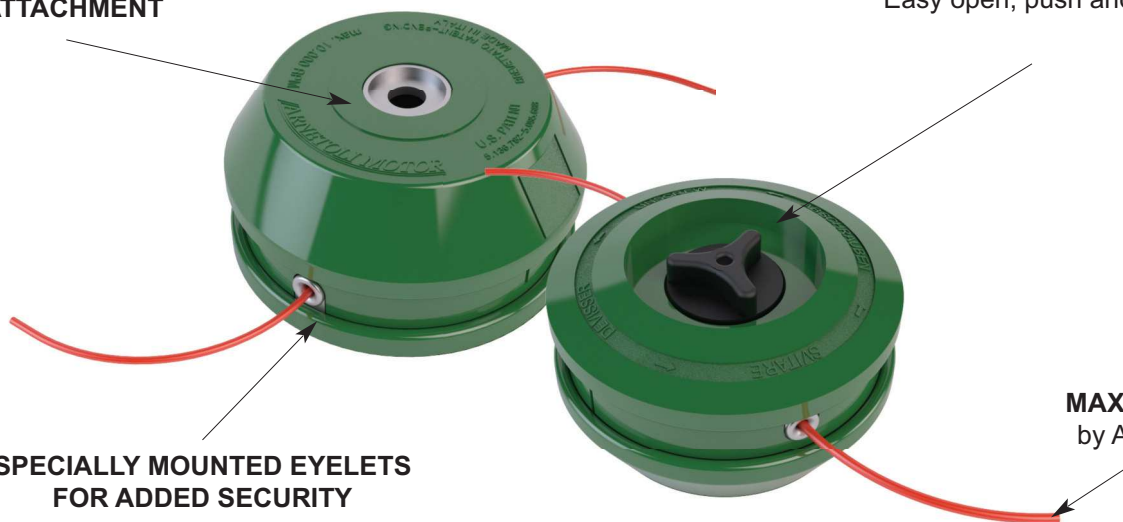

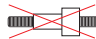
- 2 LINE UNIVERSAL
- SEMI-AUTOMATIC LINE EXTENSION
- NO SHAFT BOLT REQUIRED: SAME MOUNTING PROCEDURE AS DISC BLADE 
- SPOOL CAPACITY: UP TO 13 M (DIA. 2.4 MM)
- FITS ALL OF BRUSH CUTTER/TRIMMER MODELS

<b>Code</b>
F202M

### Components

Ref.	Pc.	Code	Description
1	1	C-101044	Upper body
2	1	C-101046	Central body
3	2	C-106003	Eyelet
4	1	C-101030	Spool
5	1	I-202005	Spool ensemble (ø 2.4)
6	1	C-101043	Lower body
7	1	C-107001	Spring PFM
8	1	I-201005	Knob

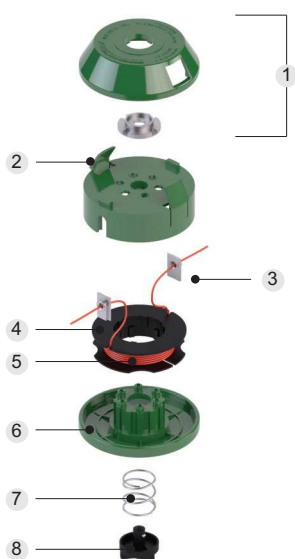

### Mounting procedure

The universal head F 202 M is mounted in the same way as a disc blade. Blade-compatible brush cutters and trimmers won't need any additional accessories to mount this head.

